

THE NEW BAR COMPOSED BY “MODULES” FOR OUTDOOR OR EVEN FOR INDOOR

Smart Bar is a new line of bar modules, for outdoor or for indoor designed and created by Moving Glass & Metal Design srl. This groundbreaking bar-concept is characterized by the reduced size of the elements (the depth of the bench is only 750mm and the length of the modules is 600mm or 1200mm) with just a few additional accessories becomes the custom bar that satisfies your needs. As well as being simple and practical in its use the Smart bar has all the elements refrigerators with connected motor and auto-evaporation of condensate water, so do not need connections to remote units.



This New “Modular” Bar is perfect for hotels, restaurants, bar kiosks but also for exhibitions, concerts, outdoor parties as it is weather resistant as entirely made of stainless steel (with the exception of the front panels which are made of waterproof MDF wood). It can easily be disassembled and transported thanks to the small footprint of the various modules and thanks to the decomposition in parts of these last elements.

The assembly can also be performed by untrained personnel with the help of a few tools, the only connections required are the ones running water (plug -in water mains) and the electrical mains (220V 50Hz) in case you have installed the refrigerated unit or the static showcase. There is also the possibility of inserting neutral angles at 90 ° in order to shape the Smart Bar as you prefer for forming counters to “L”, “U” or “Bar Islands”.

****All rights reserved.**

Reserved literary production. It is forbidden to reproduce (even partially) images, texts, prices or technical sheets, without MD&MD srl signed authorization.

THE NEW BAR COMPOSED BY “MODULES” FOR OUTDOOR OR EVEN FOR INDOOR

The Smart Bar line consists of the following elements plug to each other:

- L. 1200 mm refrigerated Display Case
- Cash Module with stainless steel drawer with key
- Beer Module (dispensing system for beer not included)
- L= 1200 mm Refrigerated Module
- Ambient Module with 2 open shelves
- Sink Module with drain hole and single-lever mixer
- Cocktail Module with berries tanks and ice tank
- Waste Module with hole + lid and stainless steel basket on wheels

SHOWCASE

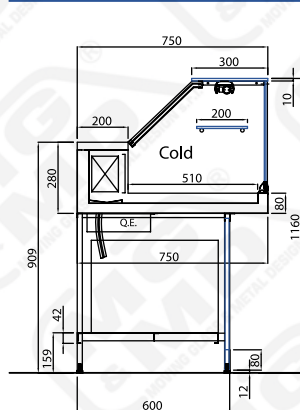

A

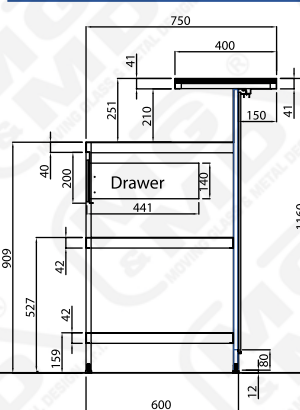

B

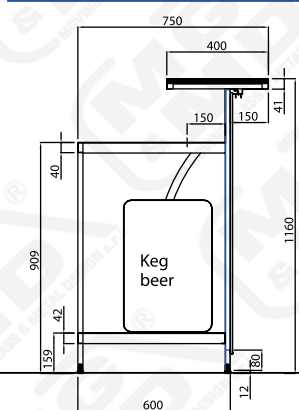

C

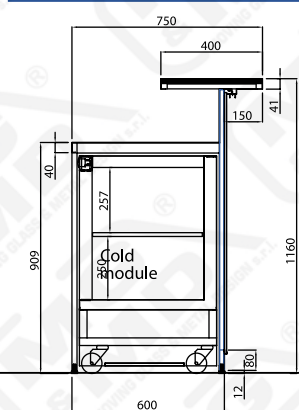

D

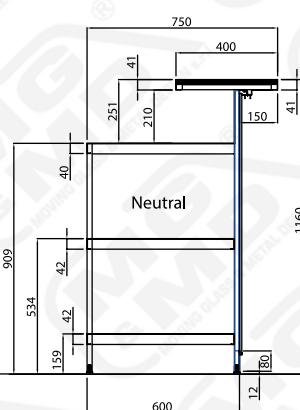

E

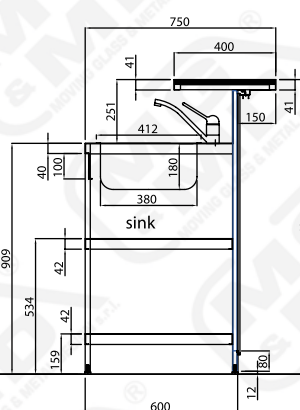

F

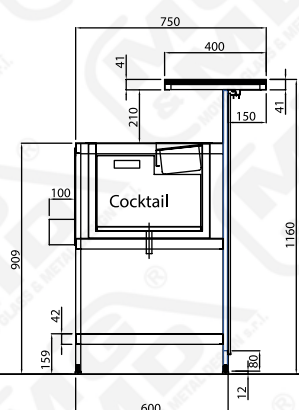

G

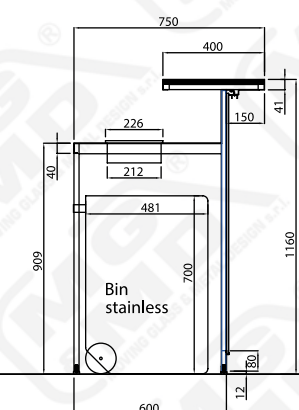

The CHARACTERISTICS of the module “Display Case” are the following:

- L = 1200 mm D = 750mm H = 1160mm
- misting resistances of front and side glasses
- (T + 4 ° / 8 ° C for sandwiches, snacks or drinks displaying) with vertical glass opening downwards (to vasistas system)
- 8 mm thick glass intermediate shelf
- 3000K or 5000K LED ceiling light
- sliding back doors in Plexiglas
- static system with R134A valve and connected motor inside the basement with auto-evaporation tank for water condensation.

➤ REFRIGERATED MODULE

The refrigerated reserve is inserted inside the L=1200 mm refrigerated module and it has the followings CHARACTERISTICS:

- L=1090 mm P=540 mm H=856 mm, on swivel wheels
- R404A valve system and built-in motor inside the base, with auto-evaporation small tank for water condensation
- Stainless steel doors, steel intermediate shelves, built-in electronic control unit and stainless steel body insulated by low density ecological polyurethane

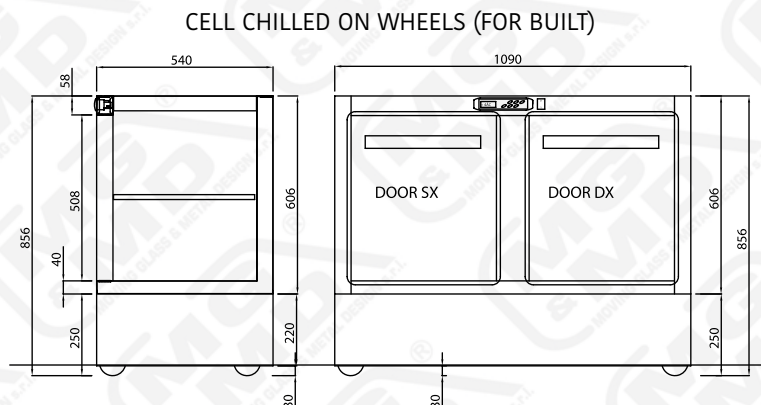

➤ COCKTAIL MODULE

The cocktail tank is inserted inside the L=600 mm cocktail module, completely made in stainless steel, insulated by low density ecological polyurethane, with welded bottom and water discharge, it includes:

- GN 1/9 H=100 mm n. 3 berries cups
- n.1 steel separator for per 2 bottles
- n. 1 tank for ice cubes or chips, on the front of the cocktail module you can hook a very useful speed rack in stainless steel which can hold 6 or 12 bottles

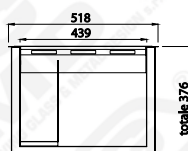

BASIN COCKTAIL
(FOR BUILT)

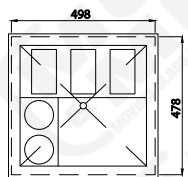

SPEED RACK 6 BOTTLES

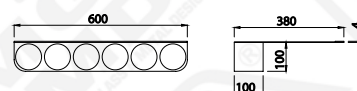

SPEED RACK 12 BOTTLES

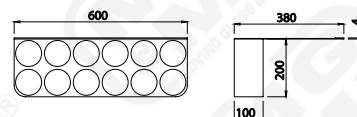

➤ COATING

The smart bar coating is composed by 20 mm thick end sides in waterproof laminate or lacquered with water-repellent MDF and by frontal panels which can be realized in glass or in waterproof MDF as the end sides. Upon request we can apply writings or business logos of any size.

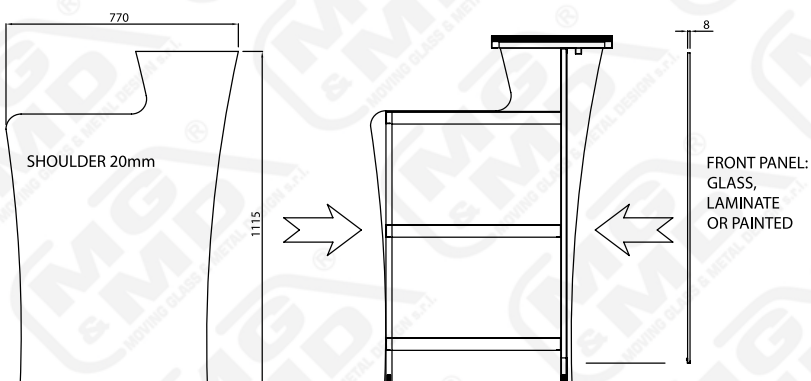

The possibilities of customization of the SMART BAR are the following:

- speed rack of 6 or 12 bottles for cocktail module
- shaped end side with laminate or lacquered panel, at your choice
- extra light back-painted front panel in tempered glass
- front panel in laminate or lacquered wood, at your choice
- RGB led lighting under the serving plan
- inclusion of one system for dispensing beer (or wine) CELLI brand
- Inclusion of one piece of furniture behind the counter for the coffee machine
- Inclusion of one piece of furniture behind the counter for washing or preparing products
- different fittings: waste hoppers, collection tanks, quick couplings, etc. ...